

Pin assignment of IN1		Wafer
Pin No.	Function	Wafer
1	L	JST B2P3-VH
2		or EQUIVALENT
3	N	

Pin assignment of CN200		Wafer
Pin No.	Function	Wafer
1	+19V	JST B6P-VH
2	+19V	or EQUIVALENT
3	+19V	
4	GND	
5	GND	
6	GND	

Pin assignment of CN201		Wafer
Pin No.	Function	Wafer
1	+12V	MOLEX 22-27-2021
2	GND	or EQUIVALENT

備註：產地標籤依業務指示加貼。

SCALE:
UNIT: mm

DIMENSIONAL TOLERANCES

(V)	()	()	()	HOLES : ± 0.2	ANGLES : $\pm 0.5^\circ$
<30	± 0.25	DECIMALS	UP~100 : ± 0.2	250~300 : ± 0.4	UP~100 : ± 1.0
>30~100	± 0.35	X	100~150 : ± 0.25	300~350 : ± 0.45	100~600 : ± 1.5
>100~300	± 0.5	X X	150~200 : ± 0.3	350~OVER : ± 0.5	600~900 : ± 2.4
ABOVE 300	± 0.6	X.XX	200~250 : ± 0.35		900~OVER : ± 3.1

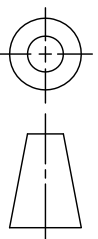

THIRD ANGLE PROJECTION

P/N.: 90C1508400

MODEL NO. : FSP150-P24-A19	TITLE: ASSY	SHEET: 1 OF 1	REV: 02
R&D	PE	DRAWN	DATE
INTERIOR COUNTERSIGN:			MAR.10.2021